

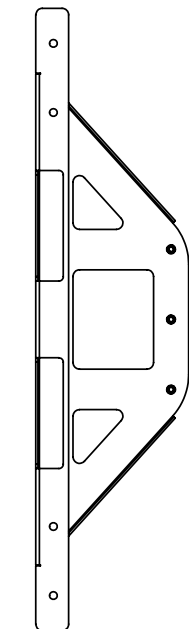

Adapter Mounting Brackets for Cisco Webex Pro

CA/MAC9 for 50" & CA/MAC10 for 75"

PARTS



Pro 75"
305-077
2x

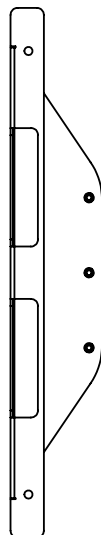

Pro 55"
305-078
2x

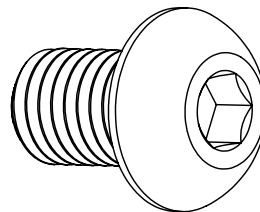

A
301-770
M10 x 16mm
4x

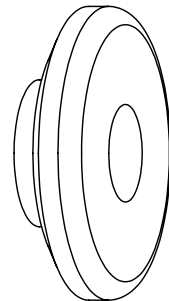

B
301-462
Shoulder Washer
4x

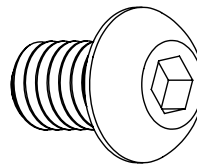

C
301-015
5/16-18 x 1/2
6x

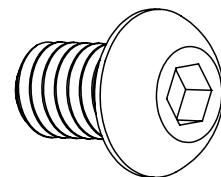

D
301-010
5/16-18 x 3/4
4x



**Requires two people to install the display on to
cart, stand, or cabinet using the supplied lifting handles.**

Mounting to Electric Lift Mobile Cart

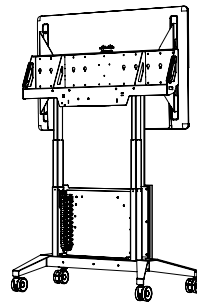

1. Attach Brackets to Display

A. Install display brackets using (4) M10 x 16mm bolts (A).

B. Loosely install (1) 5/16-18 x 3/4" bolt to the center of each display bracket. This will act as an alignment screw for the next step.

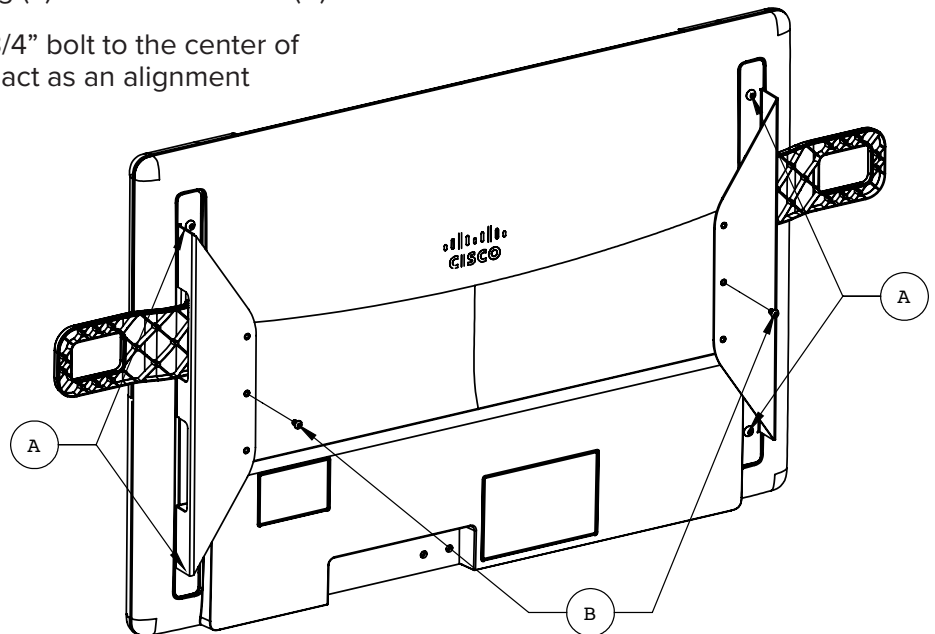

2. Attach Display to Cart

A. Position alignment screw into the "key hole" slot as shown and continue holding display.

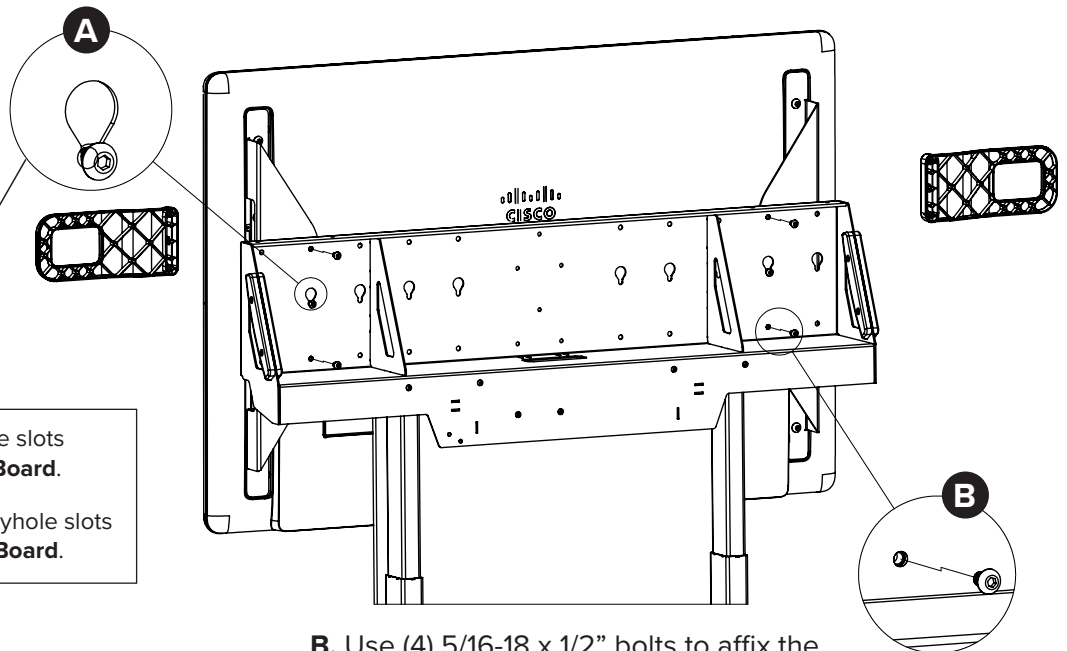

Use the outermost keyhole slots for the **75" Cisco Webex Board**.

Use the 2nd outermost keyhole slots for the **55" Cisco Webex Board**.

B. Use (4) 5/16-18 x 1/2" bolts to affix the bracket to the cart-side mechanism as shown.

Tighten all 6 screws firmly.

Mounting to Fixed Height Mobile Cart

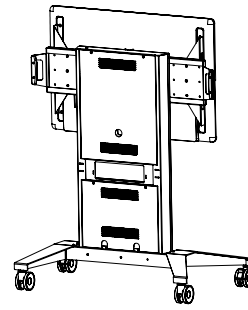

1. Attach Brackets to Display

- A.** Install display brackets using (4) M10 x 16mm bolts (A).
- B.** Attach the fixed height beam to the display brackets using the supplied 5/16-18 x 1/2" screws (C).
- C.** Attach the (4) shoulder washers (B) using the (4) 5/16-18 x 3/4" screws (D).
- D.** Refer to Fixed Height XL stand instructions for the remaining steps of mounting the beam to the cart.

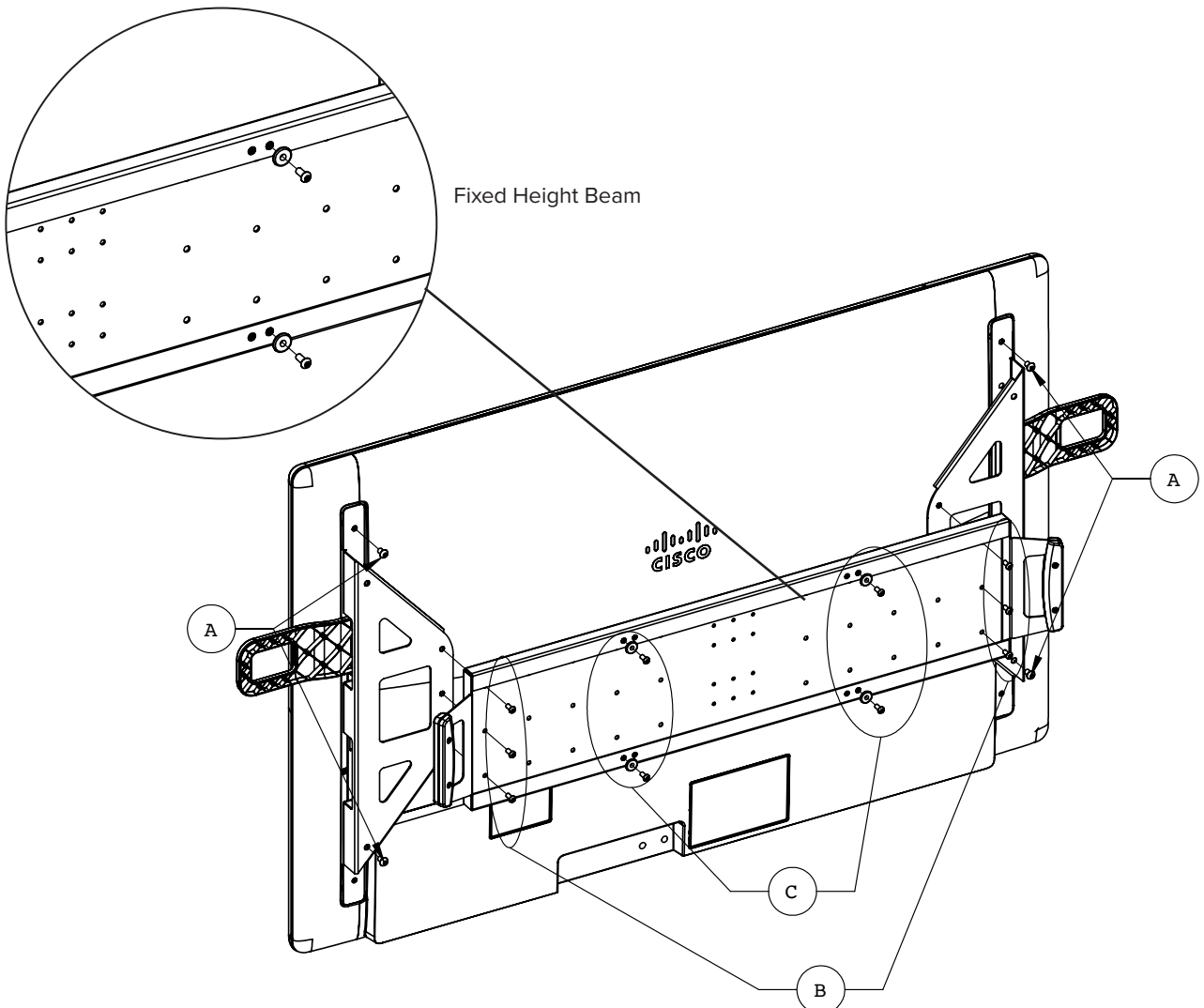

Mounting to Electric Lift Wall Stand

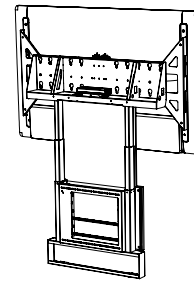

1. Attach Brackets to Display

- A. Install display brackets using (4) M10 x 16mm bolts (A).
- B. Install (4) shoulder washers (B) to the display brackets using (4) 5/16-18 x 3/4" bolts.

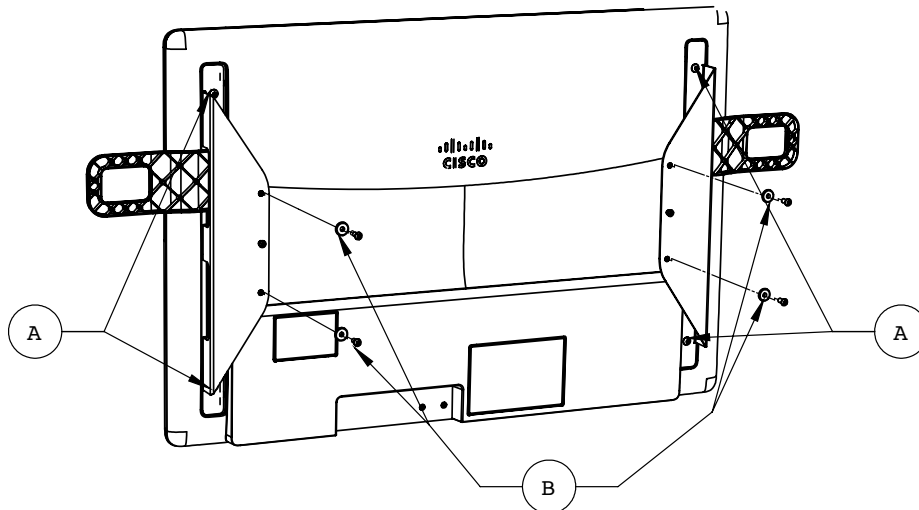

2. Attach Display to Stand

- A. Position shoulder washers and screw into the "key hole" slot as shown and continue holding display.

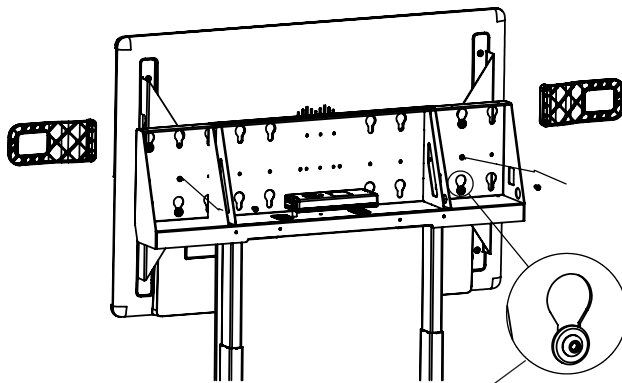

Use the 2nd outermost keyhole slots for the **55" Cisco Webex Board**.

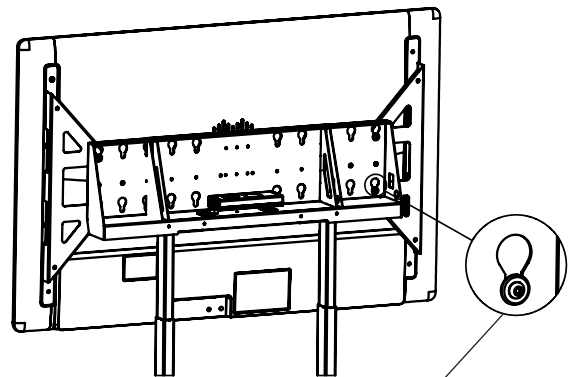

Use the outermost keyhole slots for the **75" Cisco Webex Board**.

- B. Use (2) 5/16-18 x 1/2" bolts to affix the mounting brackets to the wall stand as shown. Tighten all screws firmly.

NOTE: With larger screens it is more accessible to install locking screws with the stand all the way down and standing on a ladder.

Mounting to Cabinet

1. Attach Brackets to Display

- A. Install display brackets using (4) M10 x 16mm bolts (A).
- B. Install (4) shoulder washers (B) to the display brackets using (4) 5/16-18 x 3/4" bolts.

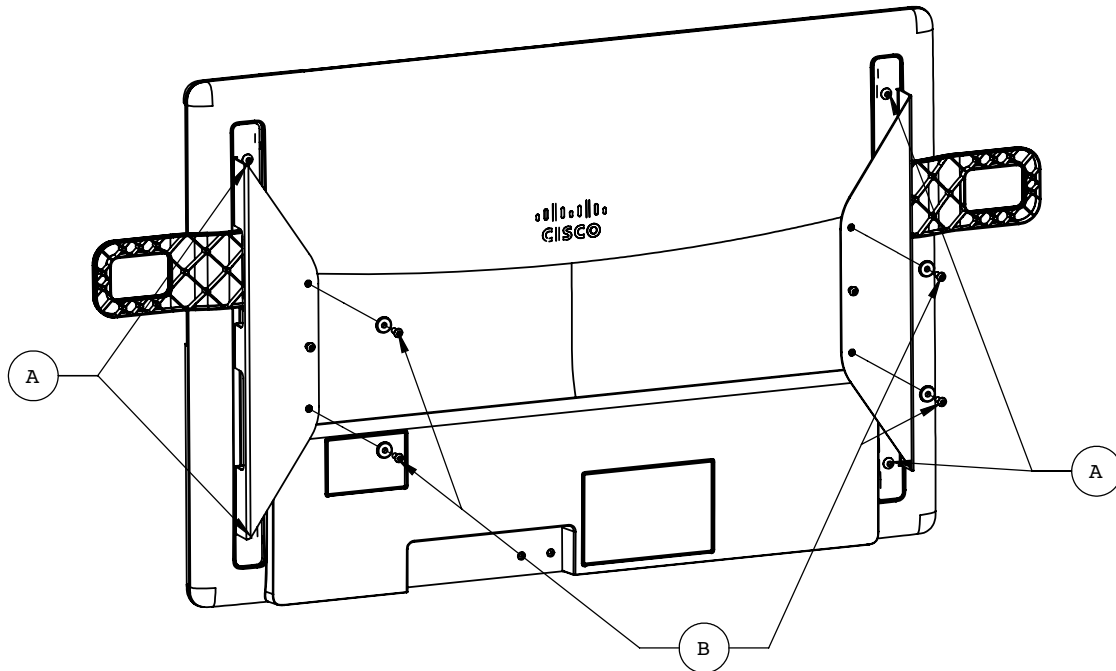

2. Attach Display to Cabinet

- A. Position shoulder washers into the “key hole” slot.
- B. Install (2) 5/16-18 x 1/2" bolts to affix the mounting brackets to the cabinet.

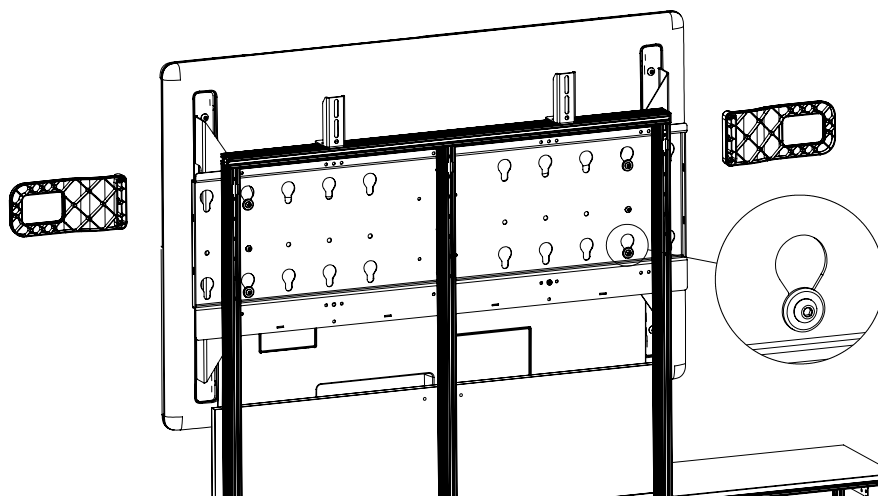

Use the outermost keyhole slots for the **75" Cisco Webex Board**.

Use the 2nd outermost keyhole slots for the **55" Cisco Webex Board**.



LIMITED WARRANTY

Salamander is proud to stand behind our products with industry-leading warranties. Should you ever encounter any problem with your Salamander product, let us know. We are here to make it right.

Full warranty including limitations and warranty claim information may be found at www.salamanderdesigns.com/commercial/warranty