

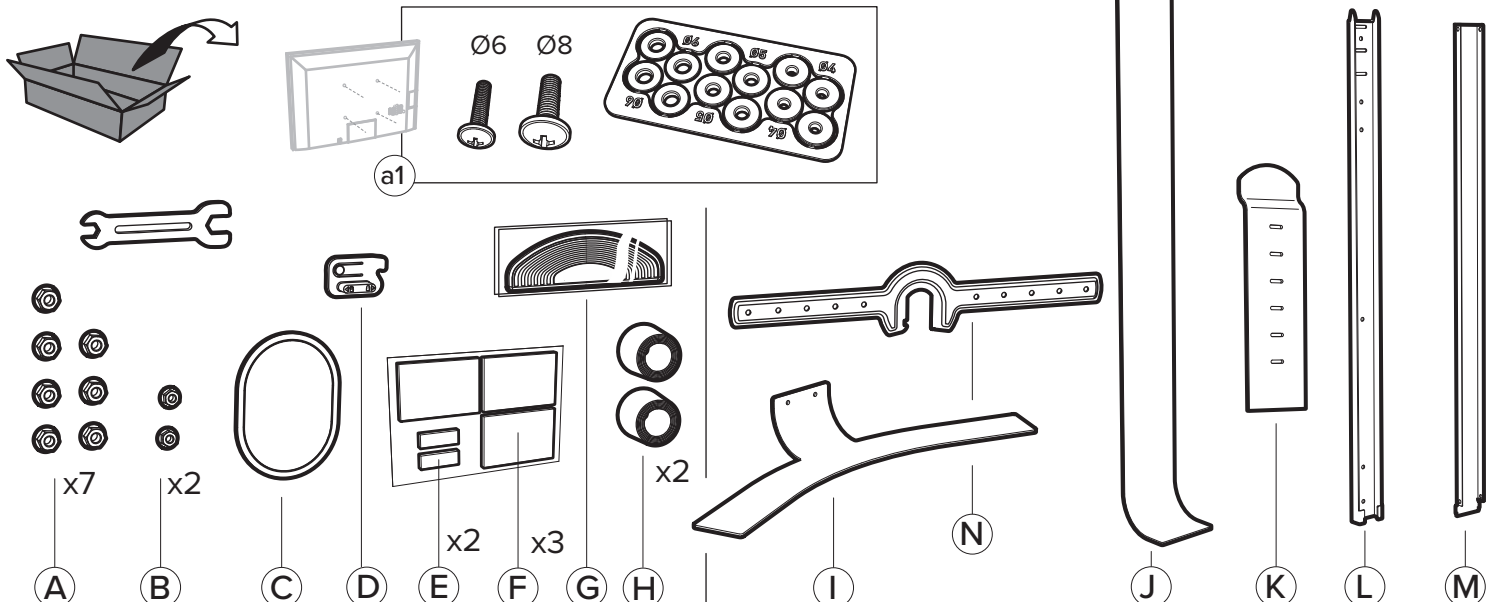

Acadia Wall Stand

Assembly Instructions

AC/W/XL600/WH

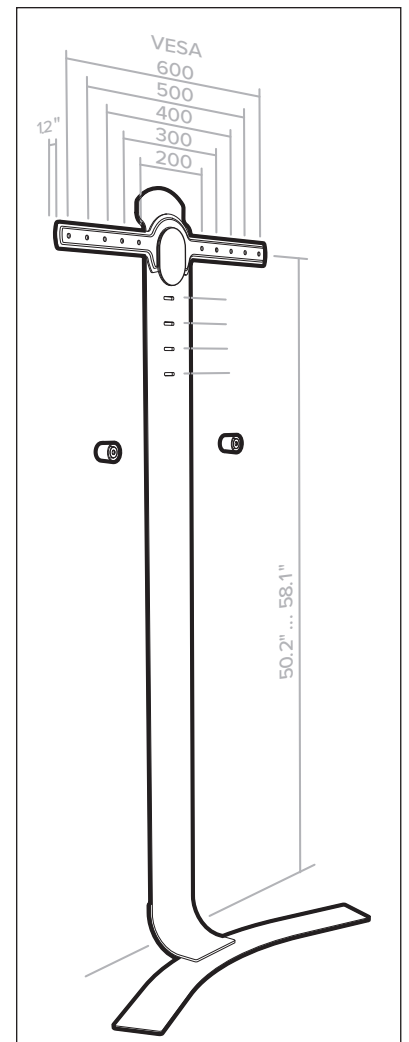
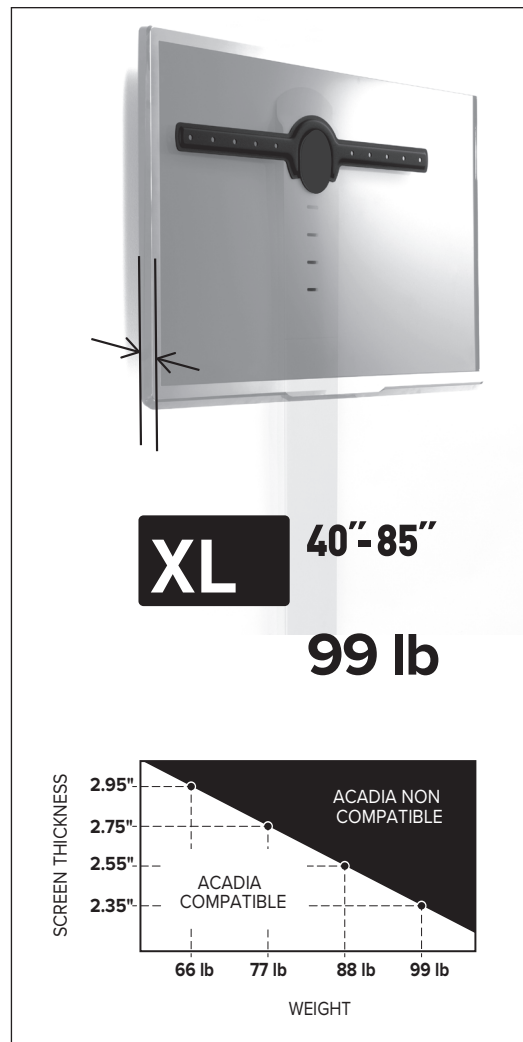

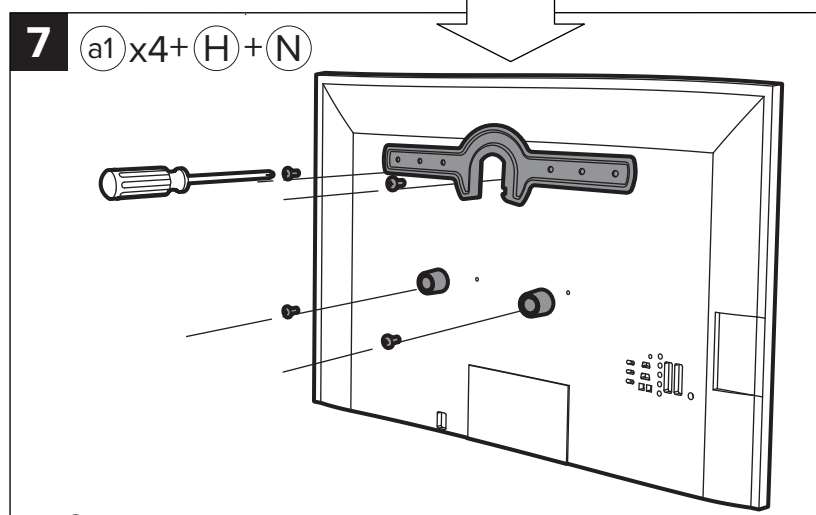
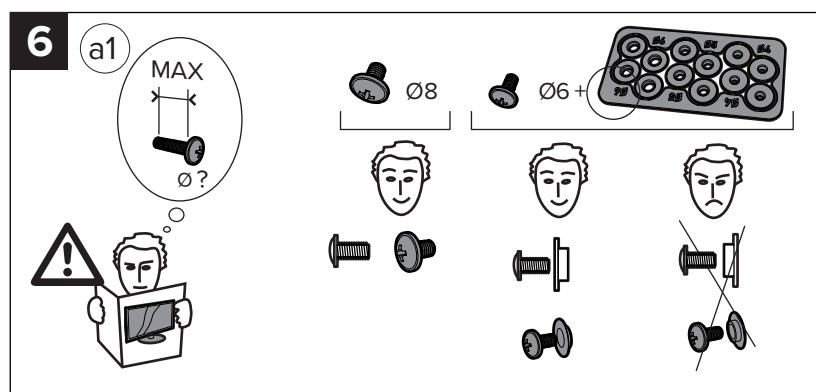
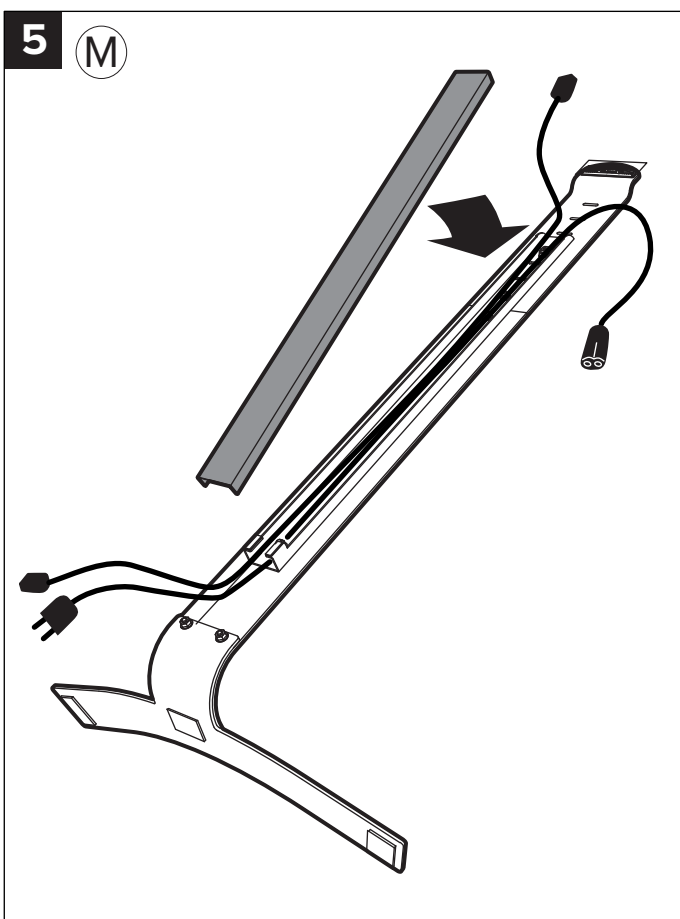
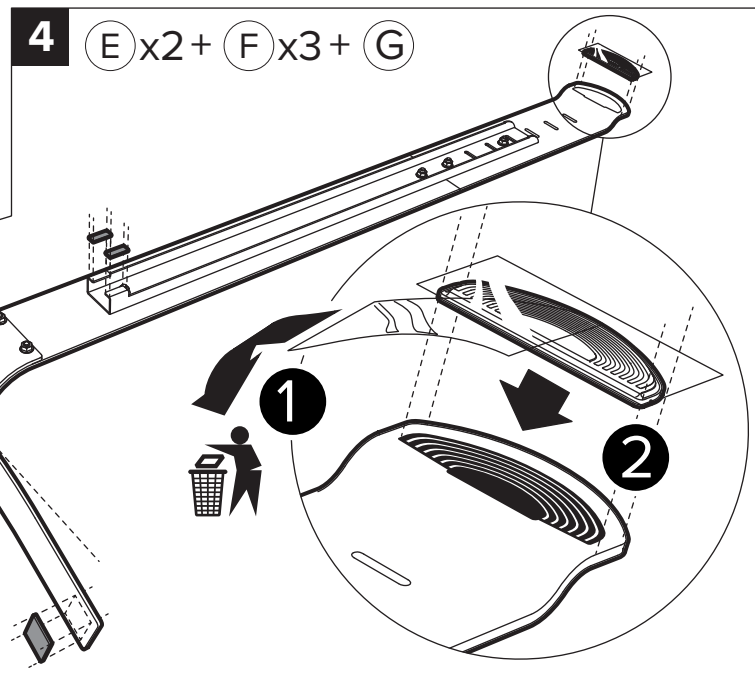
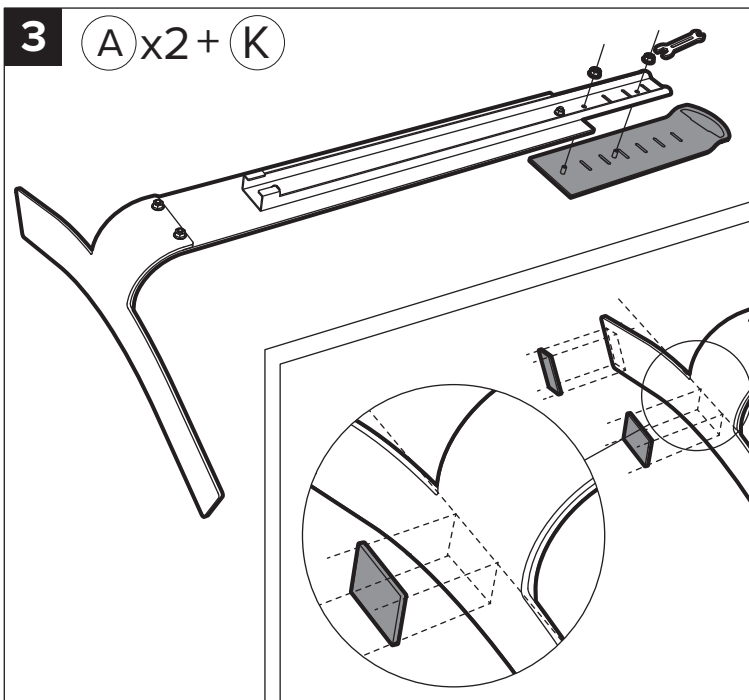
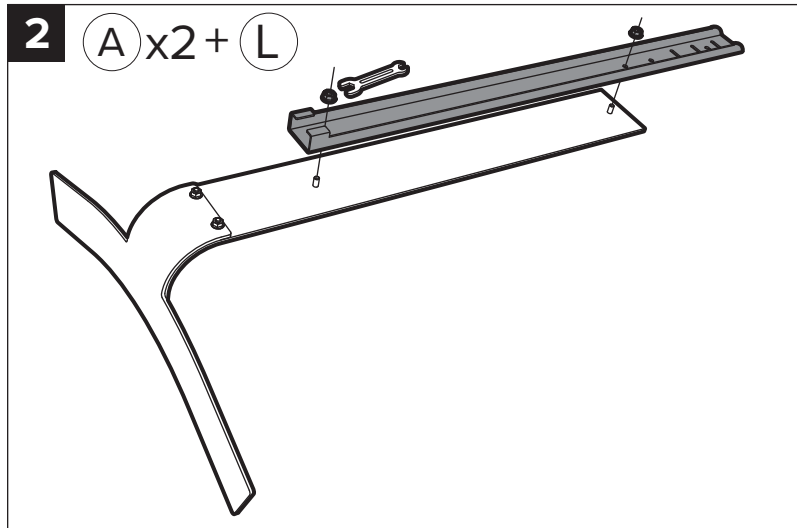
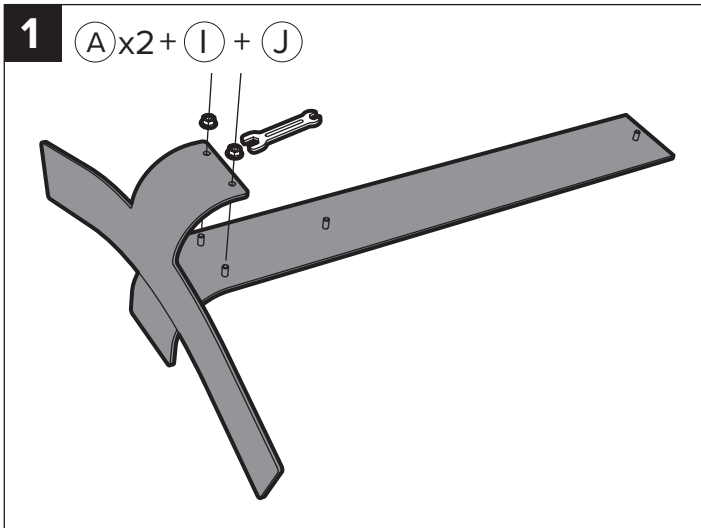

8

(B) x2 + (C) + (D)

58.1"

50.2"

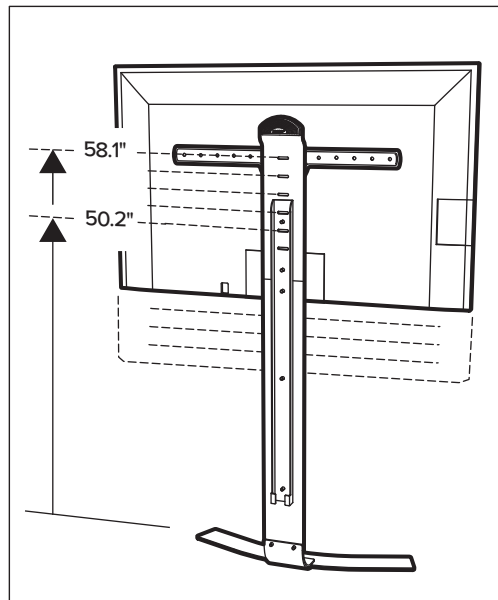
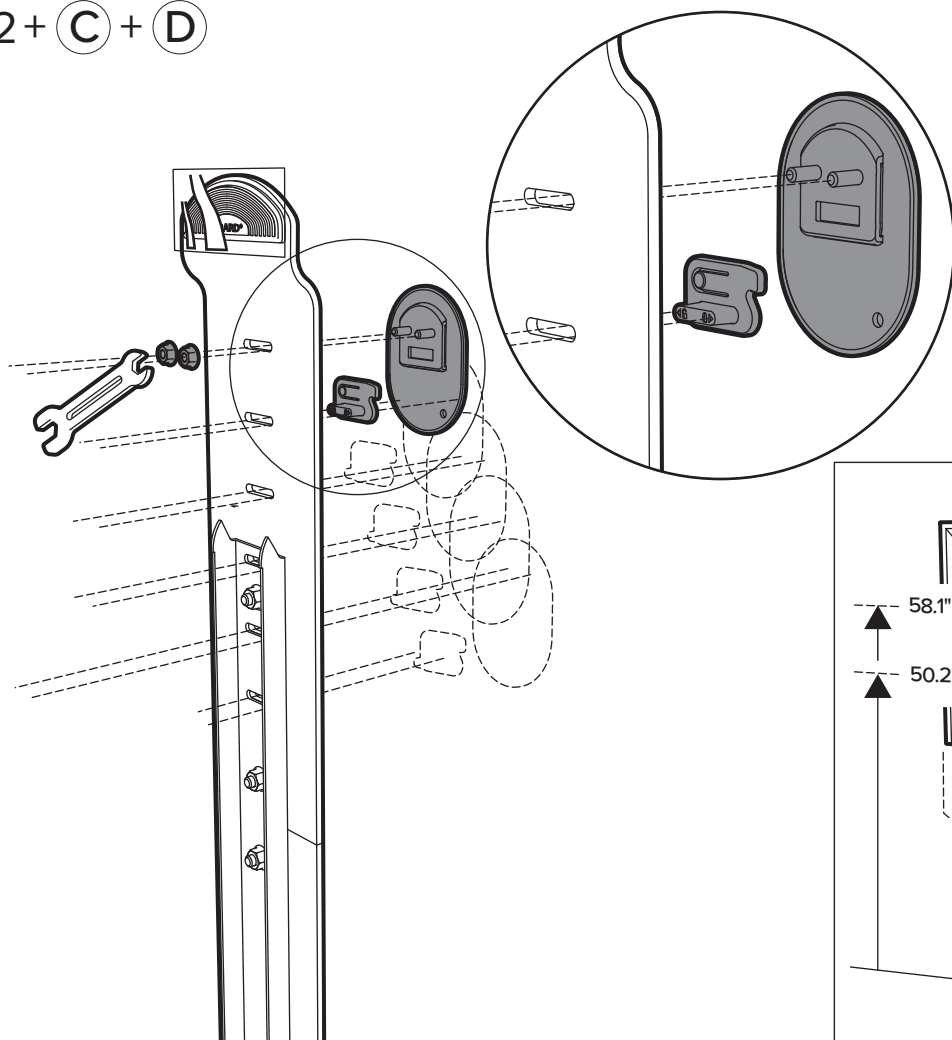

9

2

1

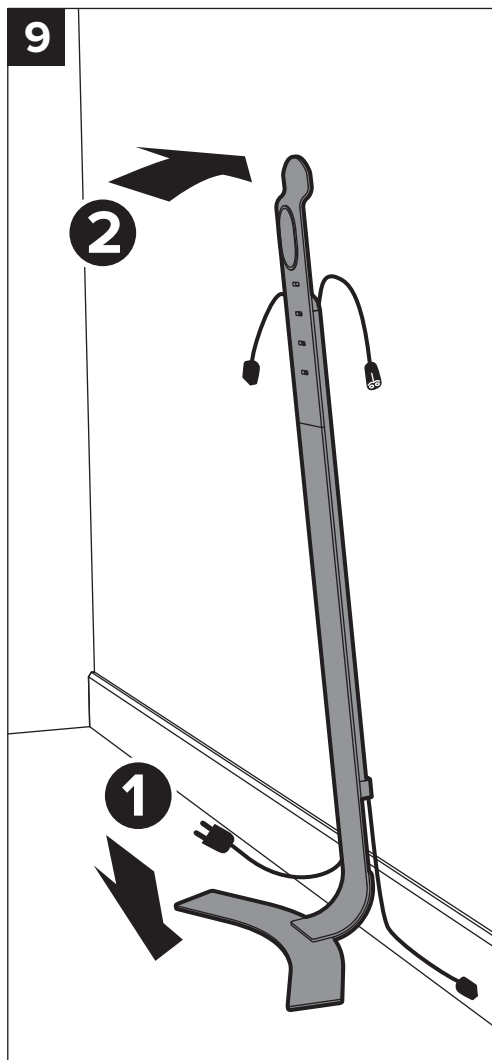

10

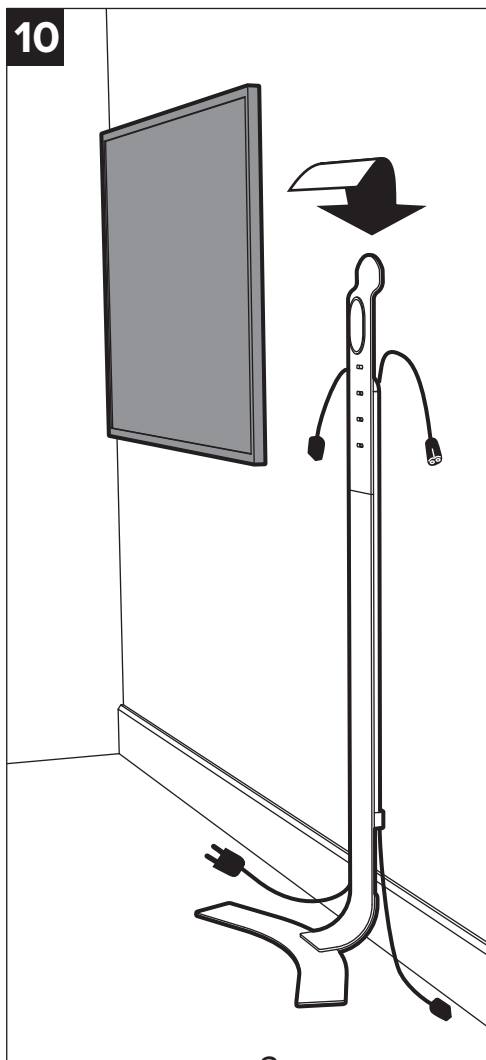

11

C + D

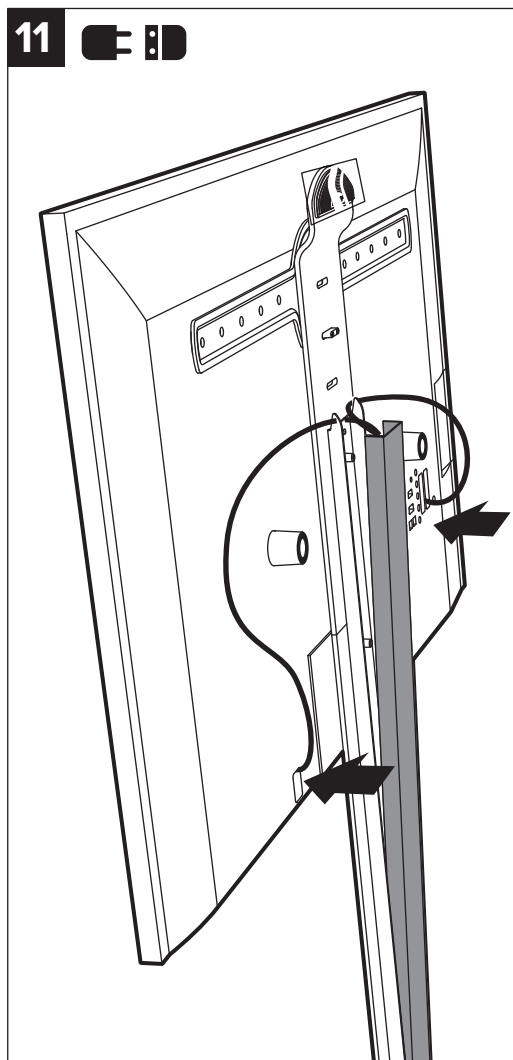

12  / 

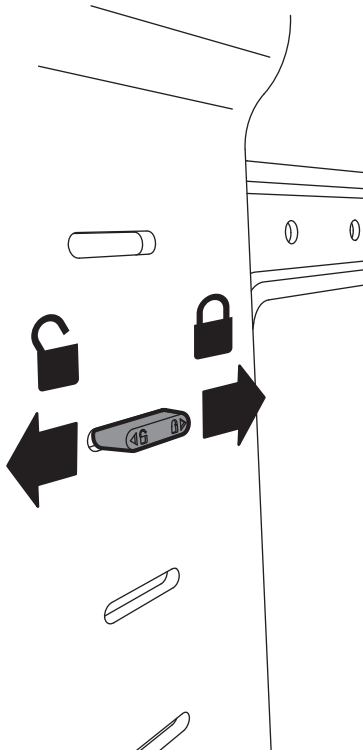

13

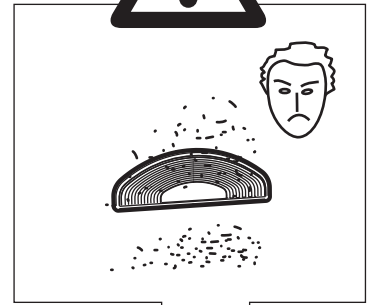
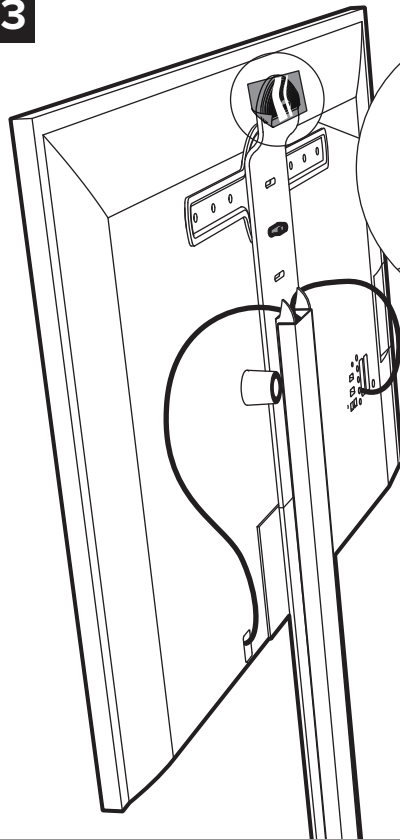

14

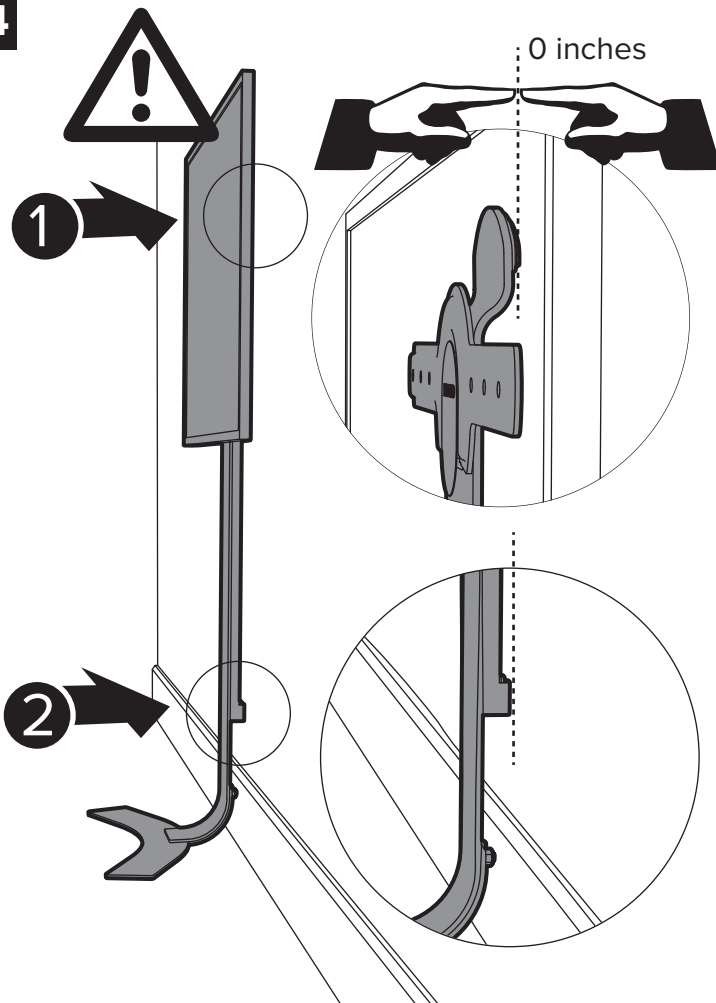

LIMITED WARRANTY

STEEL STRUCTURE CAN BE PAINTED
WITH ALKYD URETHANE PAINT.

LIMITED WARRANTY

For five full years Salamander Designs Ltd will repair or replace, at our option, any product defective in materials or craftsmanship. Salamander Designs Ltd. will not be responsible for any damage to or destruction of other equipment consequential to our equipment failure. Defective product must be given Return Authorization and is to be returned to the factory prepaid, in the original carton and packing material. Any damage incurred in a shipment not in original packaging shall be the responsibility of the owner. Warranty repairs will be returned prepaid, via UPS within the continental U.S.A. only.

WWW.SALAMANDERDESIGNS.COM